

Legend

█ County_Election_Polling_Place_2021

Election Precincts 2021

DISTRICT

- 100
- 101
- 102
- 103
- 104
- 108
- 111
- 201
- 202
- 203
- 204
- 205
- 206
- 300
- 301
- 302
- 303
- 305
- 306
- 400
- 401
- 402
- 404
- 405

Legend

All Roads

SYMB

- Undeveloped Rd
- Easment
- Easment
- Paved County Rd - Needs Repairs
- Paved County Rd
- Gravel County Rd
- Hwy and FM
- Toll Road
- Toll Ramps / Turnaround
- Private Dirt Rd
- Private Gravel Rd
- Private Paved/Cement
- Streams
- City Limits
- LCRA Lines
- River
- Railroad
- Towers
- County Line
- █ County_Election_Polling_Place_2021

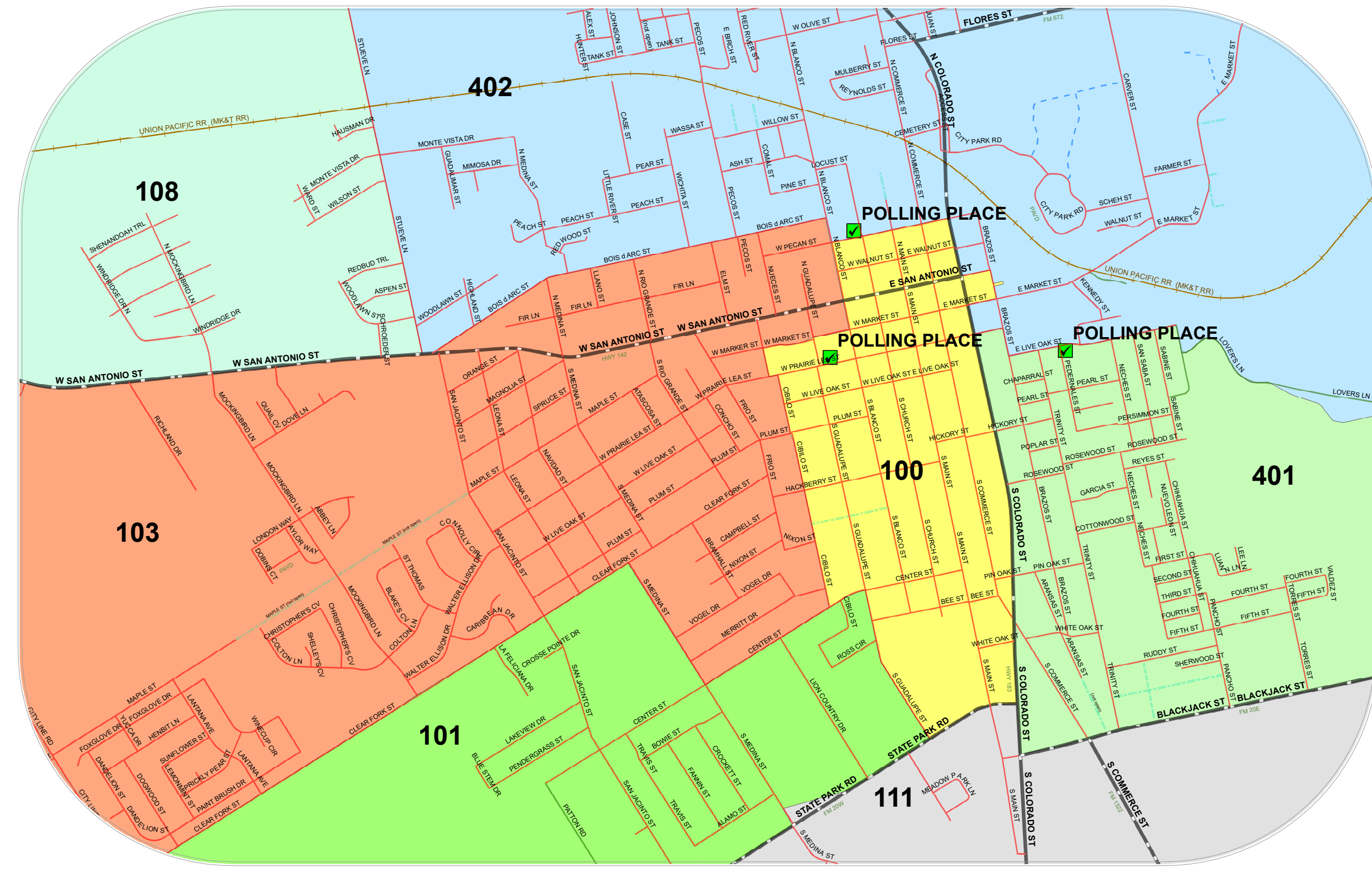
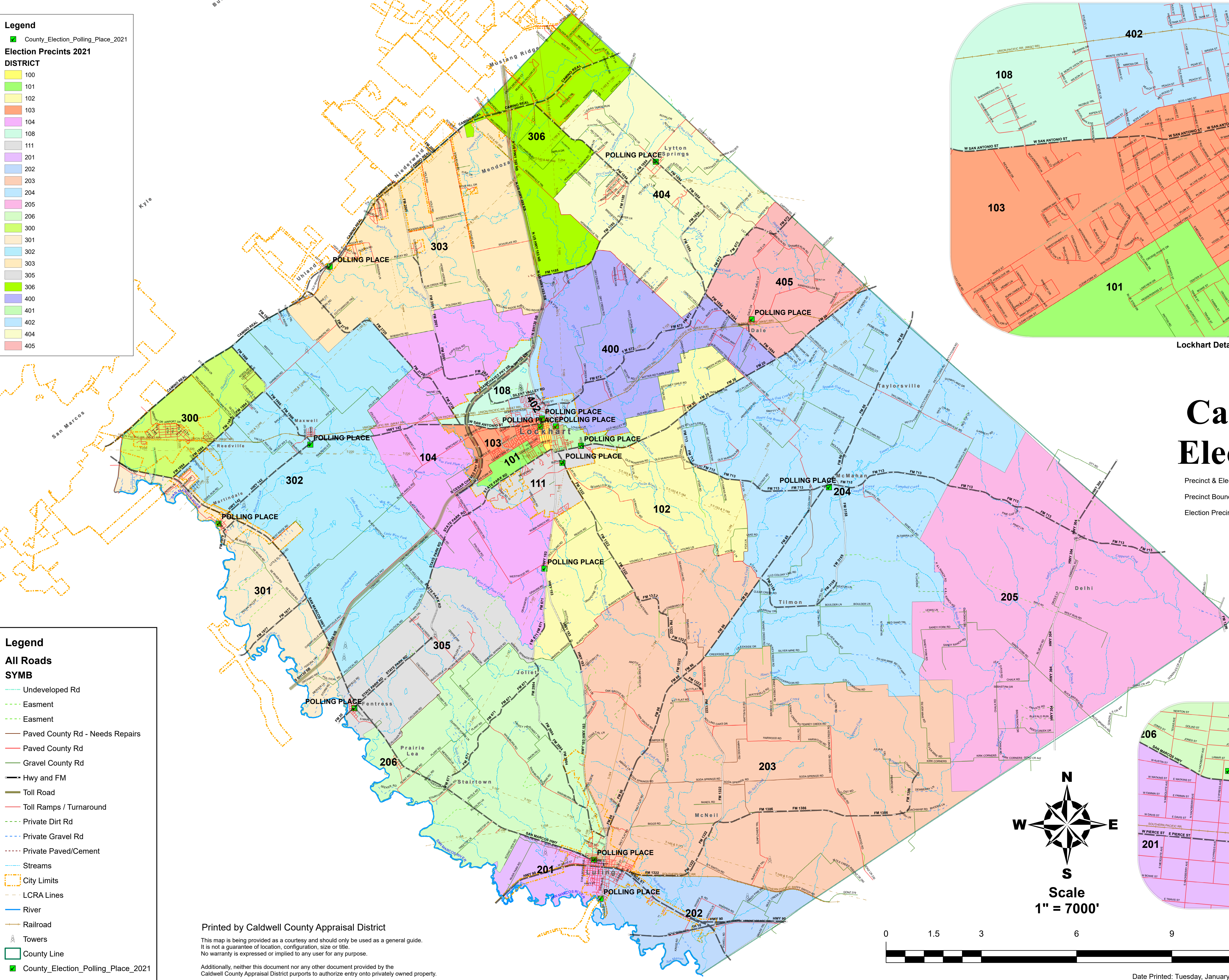

Lockhart Detail Inset

Caldwell County Election Precincts

Precinct & Election Boundaries generated by Bickerstaff Heath Delgado Acosta, LLP
 Precinct Boundaries adopted by Commissioners Court November 15, 2021
 Election Precinct Boundaries adopted by Commissioners Court December 21, 2021

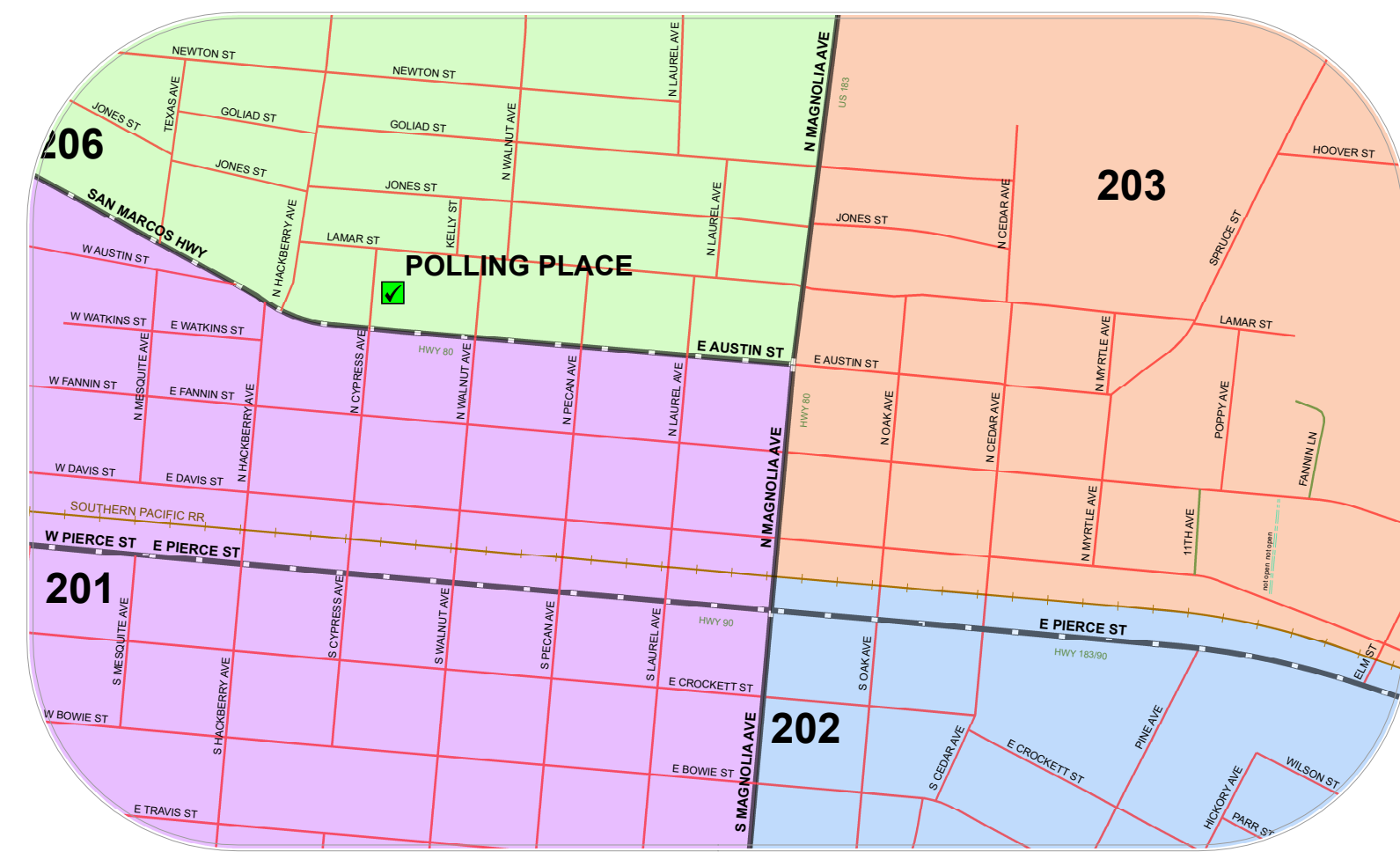

Luling Detail Inset

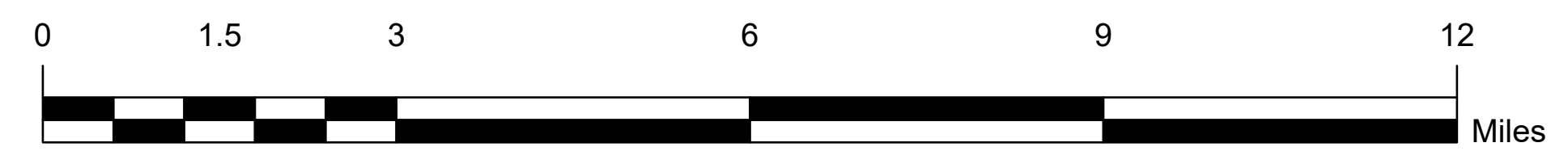
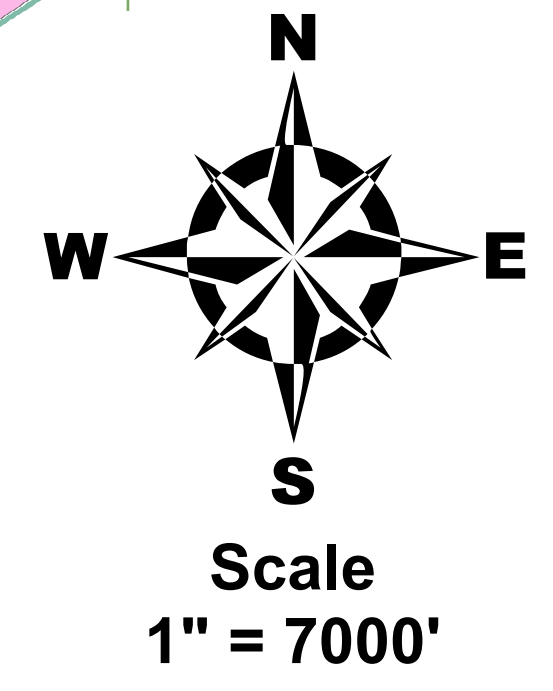

Printed by Caldwell County Appraisal District

This map is being provided as a courtesy and should only be used as a general guide. It is not a guarantee of location, configuration, size or title. No warranty is expressed or implied to any user for any purpose.

Additionally, neither this document nor any other document provided by the Caldwell County Appraisal District purports to authorize entry onto privately owned property.